



## Main

Range of product	Harmony XVU
Product or component type	Modular tower light
Beacon or indicator bank unit type	LED unit
Mounting diameter	60 mm
Component name	XVU
Light source	LED multi-colour
Light source colour	Blue Green Red White Yellow Amber
Device application	Automotive Machine tools Packaging machine

## Complementary

Signalling type	Flashing Steady Blinking Rotating
Assembly style	Customer assembly, up to 5 units Up to 4 units with buzzer
Material	PC (polycarbonate) V-0 flame retardant conforming to UL 94 PC (polycarbonate) V-2 flame retardant conforming to UL 94
[Us] rated supply voltage	24 V AC/DC
Power dissipation in W	<= 1.5 W
Current consumption	<= 70 mA
Flashing frequency	3.3 Hz fast rotating 2.33 Hz slow rotating 7.26 Hz fast flashing 0.23 Hz slow flashing 1 Hz blinking
Length	50 mm
Product weight	0.064 kg

## Environment

Product certifications	CE CSA RoHS UL
Ambient air temperature for storage	-40...70 °C
IP degree of protection	IP65
Ambient air temperature for operation	-25...50 °C
Vibration resistance	2 gn

---

Illuminated LED Unit

---

Dimensions

$\frac{\text{mm}}{\text{in.}}$

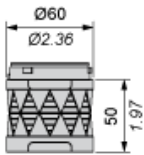

## Modular Tower Lights Mounting

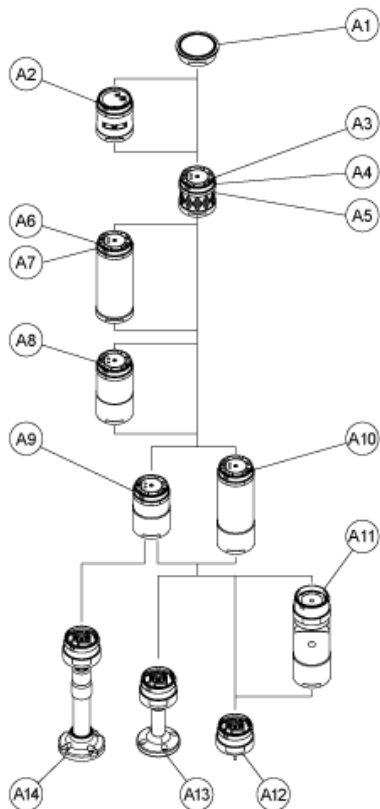

Drawing	Part number	Part name
A1	-	Top cover
-	Top cover(Silver)	
A2	XVUC9S	Buzzer unit
XVUC9SQ	Buzzer unit(Silver)	
A3	XVUC23	Green LED unit
XVUC24	Red LED unit	
XVUC25	Orange LED unit	
XVUC26	Blue LED unit	
XVUC27	White LED unit	
XVUC28	Yellow LED unit	
A4	XVUC29	Multi-LED unit
A5	XVUC29P	Multi-LED unit, Pulse signal
A6	XVUC9V	Sound unit
A7	XVUC9VP	Sound unit, Pulse signal
A8	XVUC020	Extender
XVUC020Q	Extender (Silver)	
A9	XVUC21B	DC body
XVUC21BQ	DC body(Silver)	
A10	XVUC21M	AC body NPN

Drawing	Part number	Part name
XVUC21MP	AC body PNP	
XVUC21MQP	AC body PNP(Silver)	
A11	XVUZ06	Flexible option
A12	XVUZ01	Direct mounting plate(3 pins)
XVUZ01Q	Direct mounting plate(Silver,3 pins)	
XVUZ03	Direct mounting plate(2 pins)	
XVUZ04	Direct mounting plate(4 pins)	
A13	XVUZ02	Pole with plate
XVUZ02Q	Pole with plate(Silver)	
A14	XVUZ05	Adjustment pole

Illuminated Units, Multi-LED and Audible Units Wiring

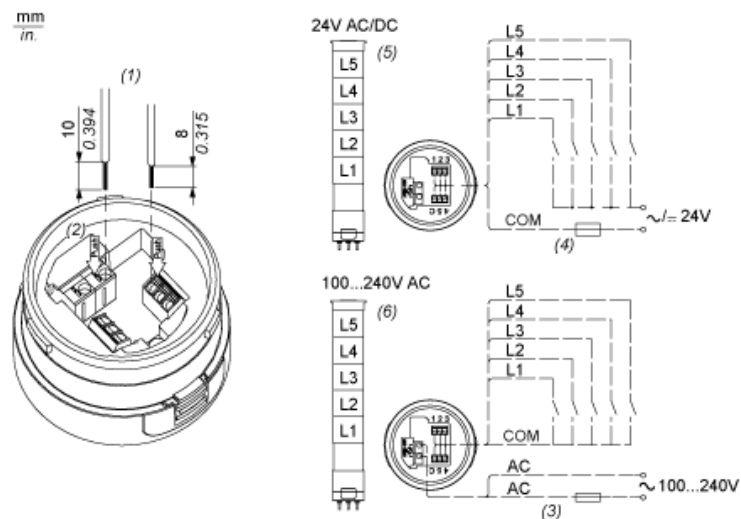

- (1) Dimensions of Wiring size
  - (2) Push-in Wire Connectors
  - (3) Fuse : 2A ,250V
  - (4) Fuse : 0.5A ,125V
  - (5) Modular Tower Lights 24V AC/DC
  - (6) Modular Tower Lights 100...240V AC
- L1 to Illuminated LED Units  
L5 :